

SQUARES

ASTM A36

Stock Length 20'

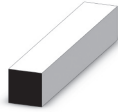

Size Inches	Weight Per Ft. Lbs.	Wt. of 20' Bar
3/8	0.478 . . .	9.56
1/2	0.850 . . .	16.99
5/8	1.330 . . .	26.59
3/4	1.910 . . .	38.21
7/8	2.600 . . .	52.01
1	3.400 . . .	67.99
1-1/4	5.310 . . .	106.20
1-1/2	7.650 . . .	153.00
2 (RND CORNER)	13.600 . . .	272.00
2-1/2	21.250 . . .	425.00
3	30.641 . . .	612.82

ROUNDS

7/16 & under-low carbon

uncertified; 1/2 & over ASTM A36

Stock Length 20'



Size Inches	Weight Per Ft. Lbs.	Wt. of 20' Bar
1/4	0.167 . . .	3.34
5/16	0.261 . . .	5.23
3/8	0.376 . . .	7.51
7/16	0.511 . . .	10.22
1/2	0.668 . . .	13.36
9/16	0.845 . . .	16.90
5/8	1.040 . . .	20.81
11/16	1.260 . . .	25.20
3/4	1.500 . . .	30.00
7/8	2.040 . . .	40.80
1	2.670 . . .	53.40
1-1/8	3.380 . . .	67.61
1-1/4 (24'1" AVAIL) . .	4.170 . . .	83.40
1-3/8	5.050 . . .	100.99
1-1/2	6.010 . . .	120.19
1-3/4	8.180 . . .	163.61
2	10.680 . . .	213.60
2-1/4	13.520 . . .	270.41
2-3/8	15.060 . . .	301.20
2-1/2	16.690 . . .	333.79
2-3/4	20.190 . . .	403.80
3	24.030 . . .	480.60
6	96.224 . . .	1924.00

Most hot finished items can be ordered pickled and oiled or galvanized upon request.